

Glass House Fabrication and Facilities At Department of BT&BI

Glass House is the fabricated structure for growing plants by optimizing conditions like temperature, light, and humidity for their rapid growth and development. It is made up of glass with aluminum framing. All glasses installed in the structure are toughened glass with temperature reflector coating. There is a cooler in four chambers for temperature maintenance and also a cooling system with humidity control (Bhanu Biotech. Pvt. Ltd) installed in chamber no.3 of the glasshouse. Its dimensions are L x B x H : 15M 50CM X 9M 90CM X 3M 35CM. Plants from the wild are collected and conditioned here for their micropropagation and other experimental studies. In vitro-raised plants are also hardened here for their transplantation in fields. Propagation and cultivation of plants are carried out under optimized conditions under a glasshouse set up for year-round availability.

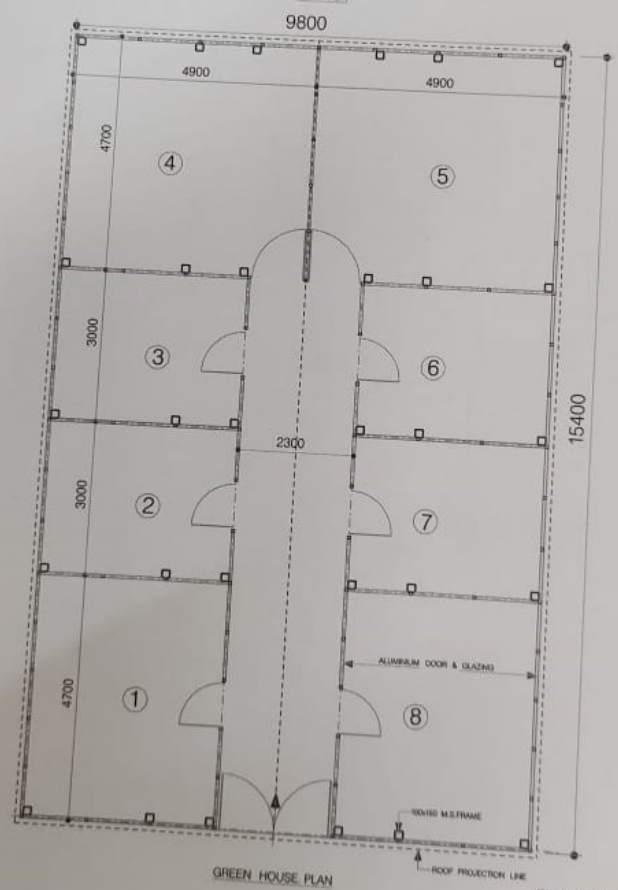

GLASS HOUSE -FRONT VIEW



EXISTING GREEN HOUSE IN
 +4. LEVEL TERRACE - JUIT, WAKNAGHAT
 20-08-2018.

GREEN HOUSE -OUTLAY PLAN

INSIDE GREEN HOUSE



GPS Map Camera

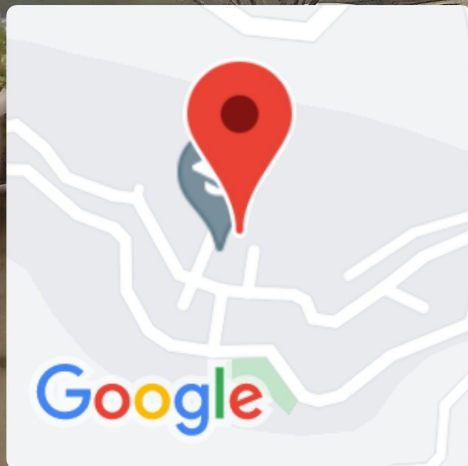

Solan, Himachal Pradesh, India

238C+F44, Solan, Himachal Pradesh 173221, India

Lat 31.016747°

Long 77.070357°

28/07/22 10:40 AM

GREEN HOUSE

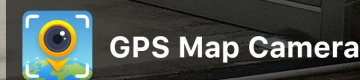

GPS Map Camera

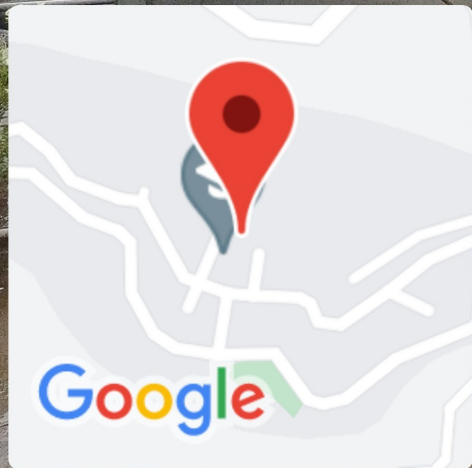

Solan, Himachal Pradesh, India

H-9 12, JUIT-Waknaghat Rd, Himachal Pradesh 173221, India

Lat 31.016766°

Long 77.070334°

28/07/22 10:40 AM

GREEN HOUSE



GPS Map Camera

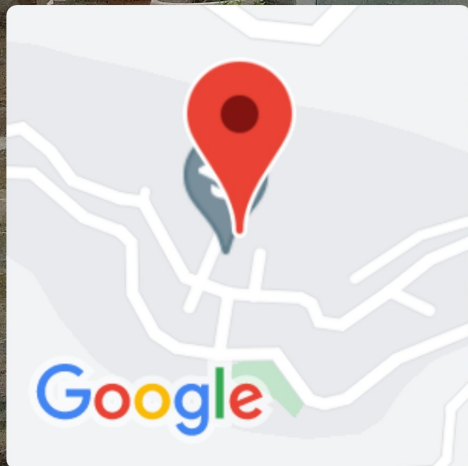

Solan, Himachal Pradesh, India

H-9 12, JUIT-Waknaghat Rd, Himachal Pradesh 173221, India

Lat 31.016775°

Long 77.070299°

28/07/22 10:41 AM

GREEN HOUSE



GPS Map Camera



Solan, Himachal Pradesh, India

238C+F44, Solan, Himachal Pradesh 173221, India

Lat 31.016627°

Long 77.070431°

28/07/22 10:41 AM

GREEN HOUSE



GPS Map Camera

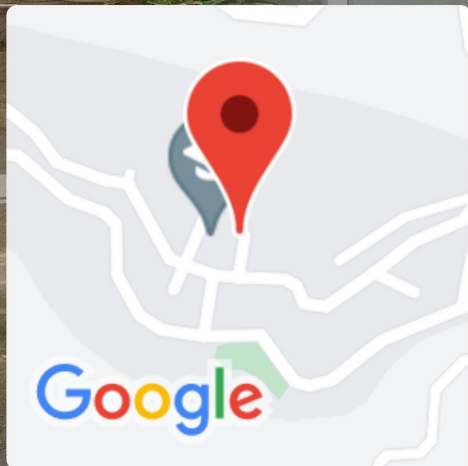

Solan, Himachal Pradesh, India

238C+F44, Solan, Himachal Pradesh 173221, India

Lat 31.016614°

Long 77.070452°

28/07/22 10:42 AM